

PLOT PARAMETERS: FILE: \\V:\PROJECTS\CAD\2015\G220\CON
 PLOTTED ON: 1/26/2016 11:21:18 AM BY USER: NWA
 USING: HPGL-2 PLOTTER: HP DesignJet 2400-60, 1/16"

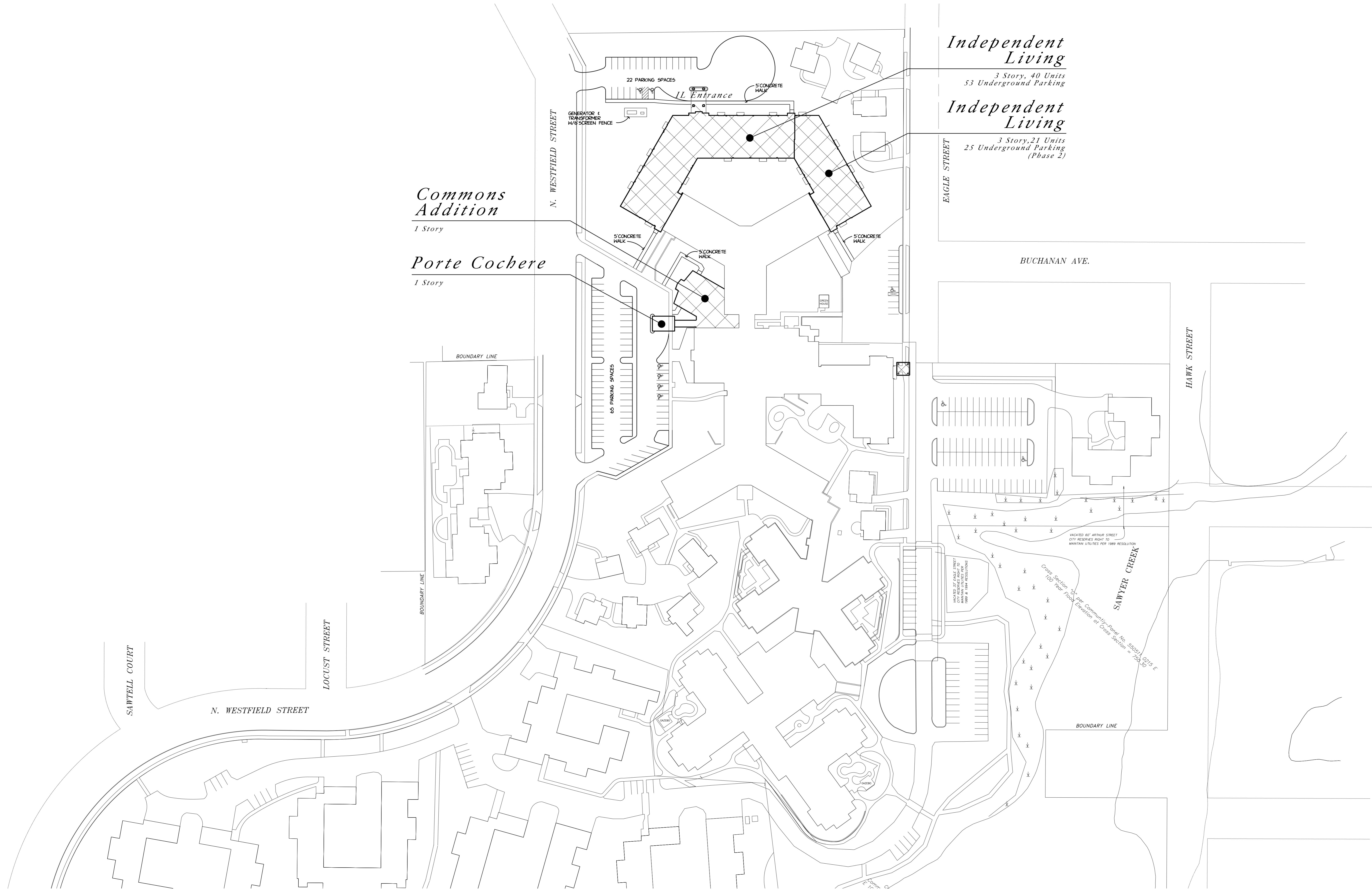

1414 UNDERWOOD AVE.
 WAUWATOSA, WI 53213
 414.431.3131 TEL
 414.431.0331 FAX
 WWW.AGARCH.COM
 Architecture
 Engineering
 Planning

REVISIONS

DESIGN DEVELOPMENT
 NOT FOR
 CONSTRUCTION

THIS DRAWING, ITS DESIGN CONCEPT AND ITS DETAILS ARE
 THE SOLE PROPERTY OF AG ARCHITECTURE, INC. AND SHALL
 NOT BE COPIED IN ANY FORM OR MANNER WITHOUT
 WRITTEN AUTHORIZATION OF ITS DESIGNER/CREATOR

DRAWN BY
 DATE
 22 JAN 2015
 PROJECT
 150201
 SHEET NO.

1:60 SITE PLAN G220
 TYPICAL

Evergreen Phase 6
 IL Addition & Commons Remodeling
 Oshkosh
 Wisconsin